

United States Department of the Interior
National Park Service

National Register of Historic Places
Registration Form



This form is for use in nominating or requesting determinations for individual properties and districts. See instructions in How to Complete the National Register of Historic Places Registration Form (National Register Bulletin 16A). Complete each item by marking "x" in the appropriate box or by entering the information requested. If any item does not apply to the property being documented, enter "N/A" for "not applicable." For functions, architectural classification, materials, and areas of significance, enter only categories and subcategories from the instructions. Place additional entries and narrative items on continuation sheets (NPS Form 10-900a). Use a typewriter, word processor, or computer, to complete all items.

1. Name of Property

historic name Park Lake Historic District

other names/site number N/A

2. Location

street & number Will Rogers and Lake Dr. junction

☐ not for publication

publication

city or town Santa Rosa

☐ vicinity

state New Mexico

code NM

county Guadalupe

code 019

zip code 88435

3. State/Federal Agency Certification

As the designated authority under the National Historic Preservation Act of 1986, as amended, I hereby certify that this ☒ nomination ☐ request for determination of eligibility meets the documentation standards for registering properties in the National Register of Historic Places and meets the procedural and professional requirements set forth in 36 CFR Part 60. In my opinion, the property ☒ meets ☐ does not meet the National Register Criteria. I recommend that this property be considered significant ☐ nationally ☒ statewide ☐ locally. (☐ See continuation sheet for additional comments.)

[Signature]
Signature of certifying official/Title

2/7/96
Date

New Mexico SHPO
State or Federal agency and bureau

In my opinion, the property ☐ meets ☐ does not meet the National Register criteria. (☐ See continuation sheet for additional comments.)

Signature of certifying official/Title

Date

State or Federal agency and bureau

4. National Park Service Certification

Thereby certify that the property is:

☒ entered in the National Register.

☐ See continuation sheet.

☐ determined eligible for the National Register.

☐ See continuation sheet.

☐ determined not eligible for the National Register.

☐ removed from the National Register.

☐ other, (explain): _____

[Signature]
Signature of the Keeper

Entered in the
National Register

Date of Action

3/15/96

Park Lake Historic District

Name of Property

Guadalupe, NM

County and State

5. Classification

Ownership of Property

(Check as many boxes as apply)

- ☐ private
☒ public-local
☐ public-State
☐ public-Federal

Category of Property

(Check only one box)

- ☐ building(s)
☒ district
☐ site
☐ structure
☐ object

Number of Resources within Property

(Do not include previously listed resources in the count.)

Contributing	Noncontributing	
1	0	buildings
3	0	sites
2	4	structures
0	0	objects
6	4	Total

Name of related multiple property listing

in (Enter "N/A" if property is not part of a multiple property listing.)

Hist. & Arch. Resources of the New Deal: NM

Number of contributing resources previously listed the National Register

0

6. Function or Use

Historic Functions

(Enter categories from instructions)

Recreation: outdoor recreation

Current Functions

(Enter categories from instructions)

Recreation: outdoor recreation

7. Description

Architectural Classification

(Enter categories from instructions)

Spanish-Pueblo Revival

Materials

(Enter categories from instructions)

foundation concrete

walls stone

roof asphalt

other stone, concrete, stucco,

Narrative Description

(Describe the historic and current condition of the property on one or more continuation sheets.)

**United States Department of the Interior
National Park Service**

**National Register of Historic Places
Continuation Sheet**

Section number 7 Page 1

Park Lake Historic District
Guadalupe County, NM

Description

Park Lake Historic District is a twenty-five acre property located on the east side of Santa Rosa in an area with numerous springs. It consists of one contributing building, a stone storage building; two contributing structures, stone walls and canals; four non-contributing structures, a picnic ramada, two restrooms, and a concrete swimming dock; and three contributing sites, a lake, a playing field and the landscaped area surrounding the lake. Built as a municipal park, its central feature is a lake. A sandy beach offers access to the swimming area at the west side of the lake, and masonry retaining walls line the remainder of the lake. Surrounding the lake is a park landscaped in the frontier pastoral style discussed in the context of the multiple property documentation. The park's other features are set in a series of terraces cut into the park's sloping contours to create a recreational area, informal groves of shade trees, and a series of masonry canals that drain the area and carry water from the lake to El Rito Creek flowing along the eastern boundary of the historic portion of the park. A narrow asphalt drive paralleling El Rito Creek and lined by several gravel parking areas offers access to picnic sites along the park's southern and eastern boundaries. A masonry wall lines much of the park's southern and northwestern boundaries along Blue Lake and Lake Drives. The park is in good condition and has been refurbished in recent years. As a part of the refurbishing, a deteriorated caretaker's cottage and an adjoining bathhouse have been removed; and restrooms, a picnic ramada, and a swimming pier have been added. Outside of the former north entry, a landscaped garden, not included in this nomination, has also been added. These alterations do not, however, detract from the feeling the park has as a New Deal public landscape.

Contributing Elements

Storage Building (01)

A small rectangular stone concession stand built in the Southwest Vernacular Style and now used as a storage shed, remains and is the contributing building. Located at the west side of the park on a terrace overlooking the pond, the building

**United States Department of the Interior
National Park Service**

**National Register of Historic Places
Continuation Sheet**

Section number 7 Page 2

Park Lake Historic District
Guadalupe County, NM

Description (continued)

has a flat roof with a parapet. Its windows have been boarded, but the building is in fair condition.

Stone Walls (02)

Situated on sloping ground with a residential portion of Santa Rosa lying above it to the west and El Rito Creek lying below it to the east, much of the park consists of a series of landscaped terraces stepping the slope from the higher residential area lining its western boundary to El Rito Creek lying below it to the east. All of these terraces are defined with stone retaining walls. The formal entry at the park west end is marked by a terrace formed by rough-coursed two ft. masonry walls broken by three separate stairways. The terrace, leading down to a picnic shelter, offers a framed view of the pond from the west. A larger terrace encompassing the northwest portion of the park and created by cut and fill provides space for recreation and a baseball field. The park's southern and eastern perimeters are lined by angled masonry retaining walls. East of the pond a three ft. high retaining wall punctuated with occasional stone steps marks the lowest level of the parks' formal terraces.

Masonry Canals (03)

A canal with a stone bed and rough-coursed masonry walls carries excess lake waters into El Rito Creek. Extending around the north and south perimeters of the lake, additional canals drain heavy summer rains and intermittent spring waters away from the lake.

Park Lake (04)

Park Lake is formed by spring waters impounded by an earthen embankment forming a wide terrace along its eastern perimeter. Approximately six acres, the lake is surrounded with a low stone retaining wall, broken only by a sandy bathing beach along the west side of the lake. A concrete swimming dock has replaced the original dock.

**United States Department of the Interior
National Park Service**

**National Register of Historic Places
Continuation Sheet**

Section number 7 Page 3

Park Lake Historic District
Guadalupe County, NM

Description (continued)

Landscaped Groves and Lawns (05)

Siberian elms and cottonwoods, most dating to the original WPA landscaping efforts, shade the picnic tables dispersed around the pond and contribute to the park's feeling as a New Deal park in the frontier pastoral style.

Recreation Area (06)

The northwest portion of the park consists of a large playing field that was levelled as a part of the WPA projects that carved the park out of a wetland with numerous springs. The southern portion of the area is the park's baseball field. A tennis and basketball court have been added to the northern portion but do not detract appreciably from the area's original appearance and function as a play area.

Non-Contributing Elements

Picnic Ramada (07)

A picnic ramada with a pitched roof and metal support post has been constructed on the site of the razed caretaker's cottage on the terrace between the west entry and the lake.

Restrooms (08, 09)

As a part of the park's refurbishing new restrooms were added west of the lake and near the baseball field.

Concrete Swimming Pier (10)

After the original swimming pier had deteriorated, a new concrete swimming pier was added.

After falling into neglect, in recent years the park has undergone a revival and been incorporated into a larger municipal park known as the Park Lake/Blue Hole Recreation Complex. This consolidated park extends across Rito Creek to the former fish hatchery and the Blue Hole, a regionally renowned scuba diving lake, located east of the hatchery. As indicated on the sketch map, only the portion associated with the New Deal projects at Park Lake is included in the district.

Park Lake Historic District

Name of Property

Guadalupe, NM

County and State

8. Statement of Significance

Applicable National Register Criteria

(Mark "X" in one or more boxes for the criteria qualifying the property for National Register listing)

- ☒ **A** Property is associated with events that have made a significant contribution to the broad patterns of our history.
- ☐ **B** Property is associated with the lives of persons significant in our past.
- ☒ **C** Property embodies the distinctive characteristics of a type, period, or method of construction or represents the work of a master, or possesses high artistic values, or represents a significant and distinguishable entity whose components lack individual distinction.
- ☐ **D** Property has yielded, or is likely to yield information important in prehistory or history.

Criteria Considerations

(Mark "X" in the boxes that apply.)

Property is:

- ☐ **A** owned by a religious institution or used for religious purposes.
- ☐ **B** removed from its original location.
- ☐ **C** a birthplace or grave.
- ☐ **D** a cemetery.
- ☐ **E** a reconstructed building, object, or structure.
- ☐ **F** a commemorative property.
- ☐ **G** less than 50 years of achieved significance within the past 50 years.

Narrative Statement of Significance

(Explain the significance of the property on one or more continuation sheets.)

9. Major Bibliographical References

Bibliography

(Cite the books, articles, and other sources used in preparing this form on one or more continuation sheets.)

Previous documentation on file (NPS):

- ☐ preliminary determination of individual listing (36 CFR 67) has been requested.
- ☐ previously listed in the National Register
- ☐ previously determined eligible by the National Register
- ☐ designated a National Historic Landmark
- ☐ recorded by Historic American Buildings Survey
Record # _____
- ☐ recorded by Historic American Engineering
Record # _____

Areas of Significance

(Enter categories from instructions)

social history
entertainment/recreation
landscape architecture

Period of Significance

1934-1943

Significant Dates

1934, 1940

Significant Person

(Complete if Criterion B is marked above)

Cultural Affiliation

Architect/Builder

unknown

Primary location of additional data:

- ☒ State Historic Preservation Office
- ☐ Other State agency
- ☐ Federal agency
- ☐ Local government
- ☐ University
- ☐ Other

Name of repository:

Park Lake Historic District

Name of Property

Guadalupe, NM

County and State

10. Geographical Data

Acreage of Property 25

UTM References

(Place additional UTM references on a continuation sheet)

- | | |
|---|---|
| 1. <u>113</u> <u>1529490</u> <u>138667010</u> | 3. <u>113</u> <u>1529500</u> <u>138661701</u> |
| 2. <u>113</u> <u>1529540</u> <u>138666401</u> | 4. <u>113</u> <u>1529310</u> <u>138661701</u> |
- ☒ See continuation sheet.

Verbal Boundary Description

(Describe the boundaries of the property on a continuation sheet.)

Boundary Justification

(Explain why the boundaries were selected on a continuation sheet.)

11. Form Prepared By

name/title David Kammer, Ph.D

organization contract historian

date Sept. 30, 1995

street & number 521 Aliso Dr. NE

telephone (505) 266-0586

city or town Albuquerque

state NM zip code 87108

Additional Documentation

Submit the following items with the completed form:

Continuation Sheets

Maps

A **USGS map** (7.5 or 15 minute series) indicating the property's location.

A **Sketch map** for historic district and properties having large acreage or numerous resources.

Photographs

Representative **black and white** photographs of the property.

Additional items

(Check with the SHPO or FPO for any additional items)

Property Owner

(Complete this item at the request of the SHPO or FPO.)

name _____

street & number _____ telephone _____

city or town _____ state _____ zip code _____

Paperwork Reduction Act Statement: This information is being collected for applications to the National Register of Historic Places to nominate properties for listing or determine eligibility for listing, to list properties, and to amend existing listings. Response to this request is required to obtain a benefit in accordance with the National Historic Preservation Act, as amended (16 U.S.C. 470 et seq.).

Estimated Burden Statement: Public reporting burden for this form is estimated to average 18.1 hours per response including the time for reviewing instructions, gathering and maintaining data, and completing and reviewing the form. Direct comments regarding this burden estimate or any aspect of this form to the Chief, Administrative Services Division, National Park Service, P.O. Box 37127, Washington, DC 20013-7127; and the Office of Management and Budget, Paperwork Reductions Project (1024-0018), Washington, DC 20503.

**United States Department of the Interior
National Park Service**

**National Register of Historic Places
Continuation Sheet**

Section number 8 Page 4

Park Lake Historic District
Guadalupe County, NM

Statement of Significance

Park Lake was constructed as a Federal Relief Emergency Administration (FERA), then WPA, project between 1934 and 1940. Planned to create local jobs through a public works project aimed at providing Santa Rosa with a recreational facility in the form of a municipal park, the Park Lake project provided jobs for many local men and became the center of the community's outdoor recreation. Over the years it has contributed to the city's efforts to boost itself as "the city of natural lakes." With its association as a New Deal project designed to improve the welfare of people in Santa Rosa during the Depression and to enhance the its recreational facilities, the park is eligible under Criterion A. As an excellent example of New Deal efforts to create public parks in the arid southwest through the creation of a water-based frontier pastoral city park, the park is also eligible under Criterion C.

From its founding as a town along the Chicago and Rock Island Railroad in 1902, Santa Rosa had a reputation for its many springs that percolated through the area's predominant limestone formation and then bubbled up through the eroded sandstone lying at the surface. While the nearby Blue Hole was the town's best-known small lake, city leaders also recognized the potential of the springs west of El Rito Creek as the site for a man-made lake. With the coming of the New Deal, the project received widespread local support and the city council agreed to acquire the land for the park. By 1934 crews consisting of workers drawn from local relief roles, some also supplying their teams and wagons, had begun to grade the site. Rocks for the canals and retaining walls were quarried locally and cut by workers supervised by local masons. As the masonry retaining walls and canals were completed and the pond began to fill, crews planted the Siberian elms and cottonwoods that have matured to form the park's informal groves. WPA records show that between 1935 and 1940 several projects including quarrying, lake construction and improvement, and the construction of a caretaker's quarters, projects totaling \$43,000, were carried out to complete the park.

By 1940, the town actively promoted the park as "Crystal

**United States Department of the Interior
National Park Service**

**National Register of Historic Places
Continuation Sheet**

Section number 8, 9, 10 Page 5

Park Lake Historic District
Guadalupe County, NM

Statement of Significance (continued)

Lake," urging Route 66 motorists to visit the park to picnic and swim in the spring-fed lake. In addition to attracting these visitors, Park Lake also became the center for local recreation with one account maintaining that over 1,500 people daily used the park and its spring-fed lake. Although the park suffered from periods of neglect, recent efforts to improve it have renewed the community's interest in its historic roots. The local history committee and Chamber of Commerce emphasize the role of Park Lake as an element in the town's early promotion of tourism and view the complex as the community's key outdoor recreational facility.

Bibliography

Sanchez, Rudy, member of the Santa Rosa History Committee.
Interview with David Kammer, March 23, 1993.

Santa Rosa City Council Minutes. Jan. 8, 1934 and March 30, 1934.

Smith-Wiley, Olive. A Santa Rosa Story. Privately published,
1973 (copy at Moise Memorial Library, Santa Rosa).

Geographical Data

UTM: #5 13 E529220 N3866240

Verbal Boundary Description

The Park Lake area of the SE quarter of Section 3, T 8, R 21, which is bounded on the East by Rito Creek, on the South by Blue Hole Road, on the west by Lake Drive and on the north by Will Rogers Drive.

Boundary Justification

The boundary includes only the portion of the Park Lake/Blue Hole Recreation Complex historically defined by the WPA projects that created Park Lake.

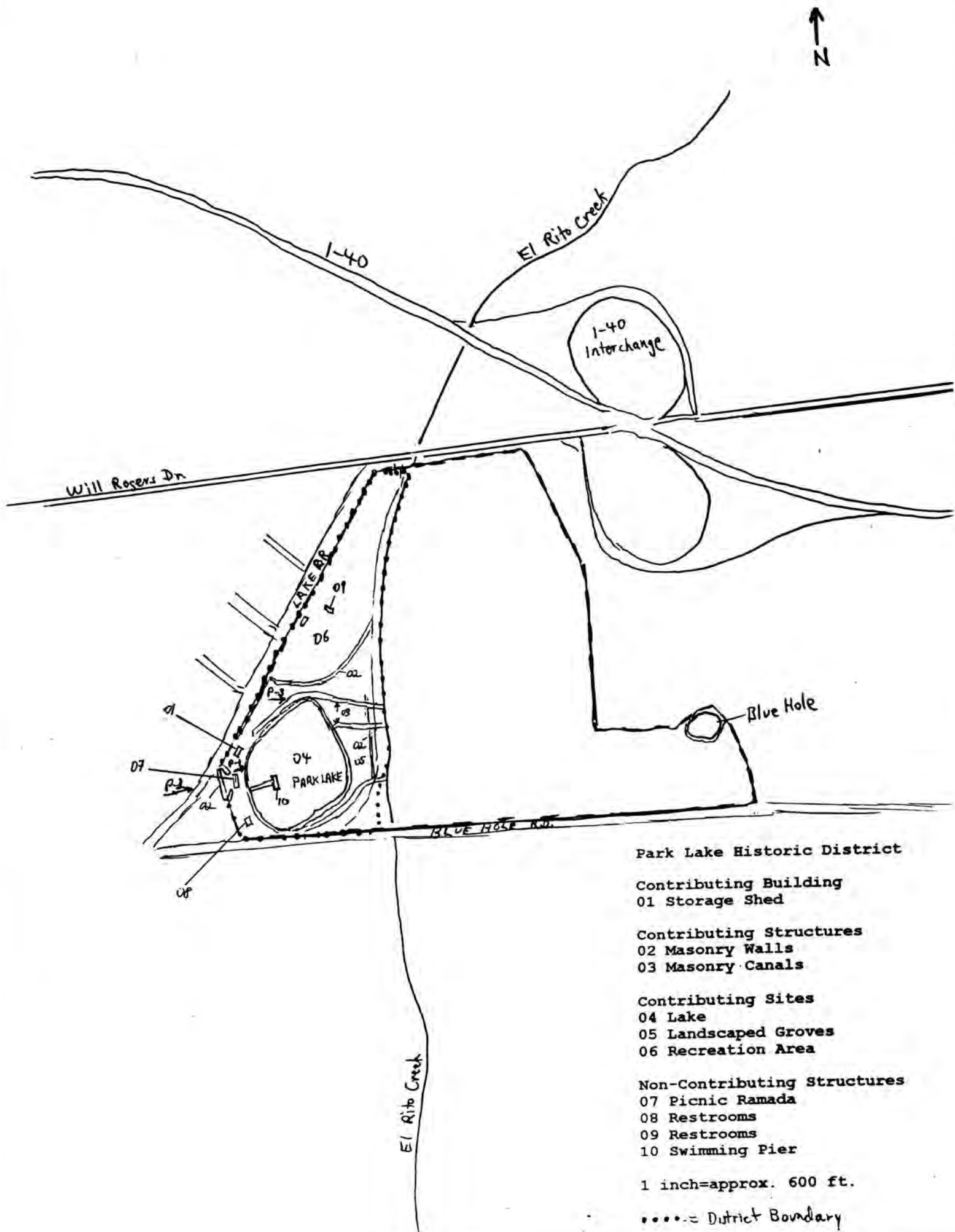

UNITED STATES DEPARTMENT OF THE INTERIOR
NATIONAL PARK SERVICE

NATIONAL REGISTER OF HISTORIC PLACES
EVALUATION/RETURN SHEET

REQUESTED ACTION: NOMINATION

PROPERTY Park Lake Historic District
NAME:

MULTIPLE New Deal in New Mexico MPS
NAME:

STATE & COUNTY: NEW MEXICO, Guadalupe

DATE RECEIVED: 2/14/96 DATE OF PENDING LIST: 2/27/96
DATE OF 16TH DAY: 3/14/96 DATE OF 45TH DAY: 3/30/96
DATE OF WEEKLY LIST:

REFERENCE NUMBER: 96000267

NOMINATOR: STATE

REASONS FOR REVIEW:

APPEAL: N DATA PROBLEM: N LANDSCAPE: N LESS THAN 50 YEARS: N
OTHER: N PDIL: N PERIOD: N PROGRAM UNAPPROVED: N
REQUEST: N SAMPLE: N SLR DRAFT: N NATIONAL: N

COMMENT WAIVER: N

☒ ACCEPT ☐ RETURN ☐ REJECT 3/15/96 DATE

ABSTRACT/SUMMARY COMMENTS:

Entered in the
National Register

RECOM./CRITERIA _____

REVIEWER _____ DISCIPLINE _____

TELEPHONE _____ DATE _____

DOCUMENTATION see attached comments Y/N see attached SLR Y/N



1. Park Lake, Park Lake Historic District
2. Guadalupe City, New Mexico
3. David Kammer
4. 6/94
5. HPD
6. E beach, picnic area in background
7. 01



1. Entry Terrace, Park Lake Historic District
2. Guadalupe city, NM
3. David Kammer
4. 6/94
5. NMHPD
6. E terraced entry and picnic shelter
7. 02



1. Canal & Retaining Walls, Park Lake Historic District
2. Grubbsville Ctr, NM
3. David Kammer
4. 6/94
5. NMHPD
6. NE canal and retaining walls
7. 03